

SCHEMATICS

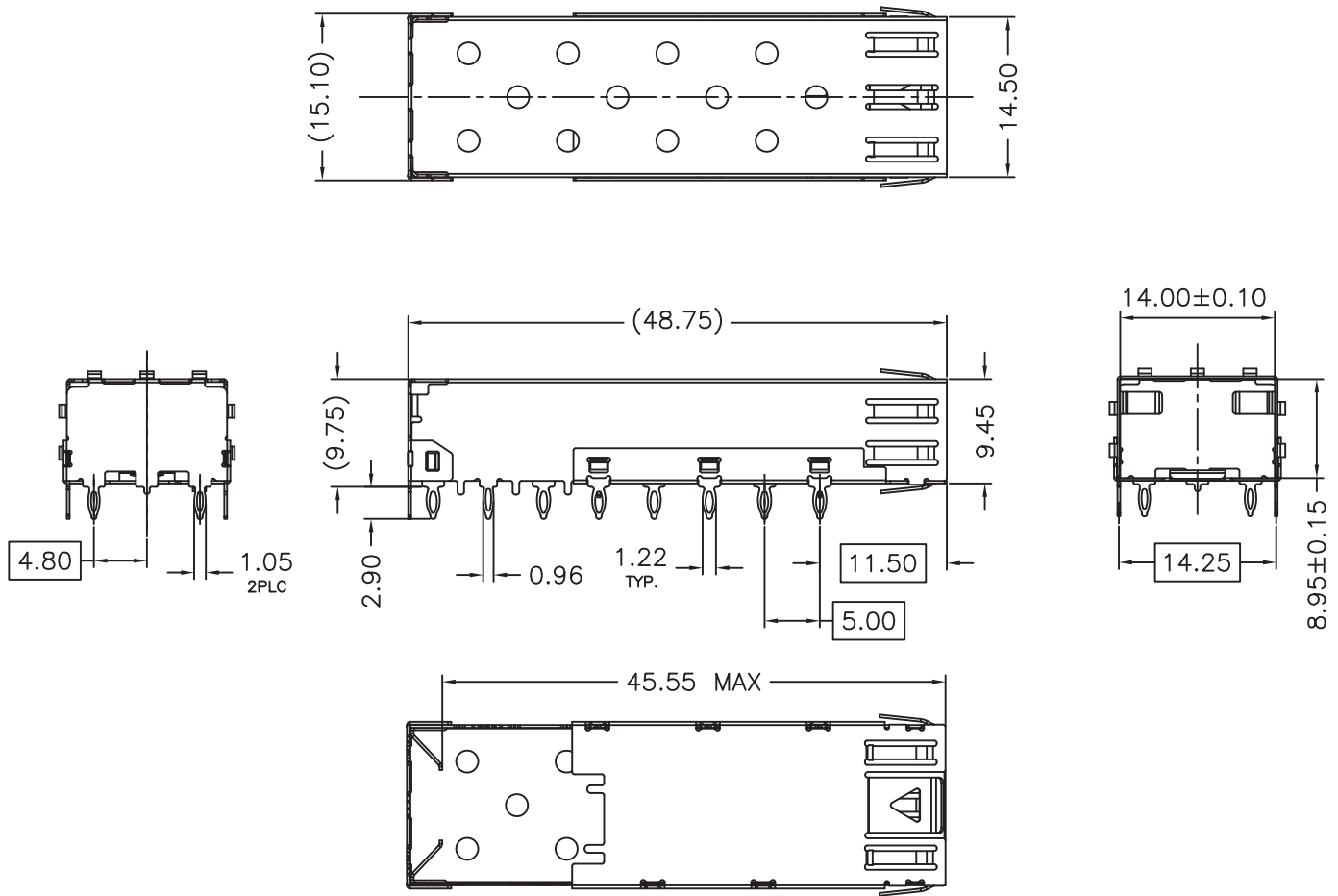

NOTES:

- 1.MATERIAL: NICKEL SILVER, THICKNESS 0.25mm
- 2.PACKAGING: TRAY PACKAGING
- 3.TEMPERATURE RANGE: -55°C TO +85°C



Drafted by:XiaoMing

Dimensions:mm

Unless otherwise specified, all tolerances are ± 0.25

SFP Cage 1x1 Press-fit Type

Approved By: TSLEE

Part No: SFP011PA

REV.
A

SHEET 1 OF 3

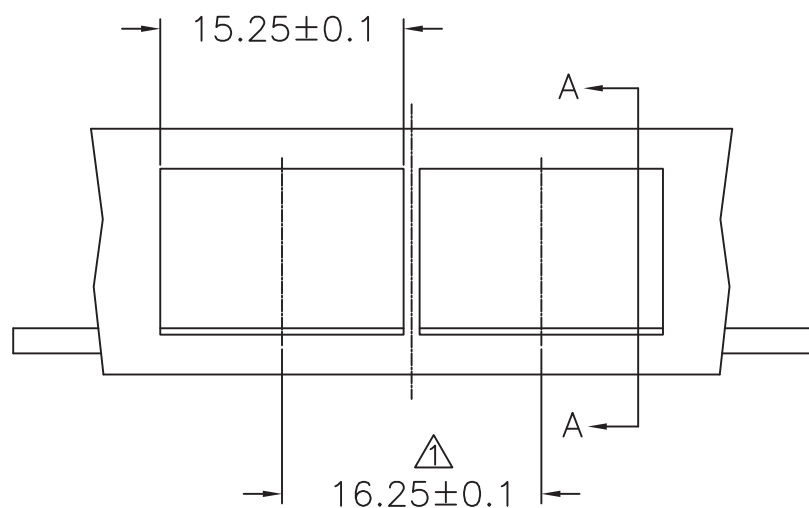

RECOMMENDED BEZEL DESIGN

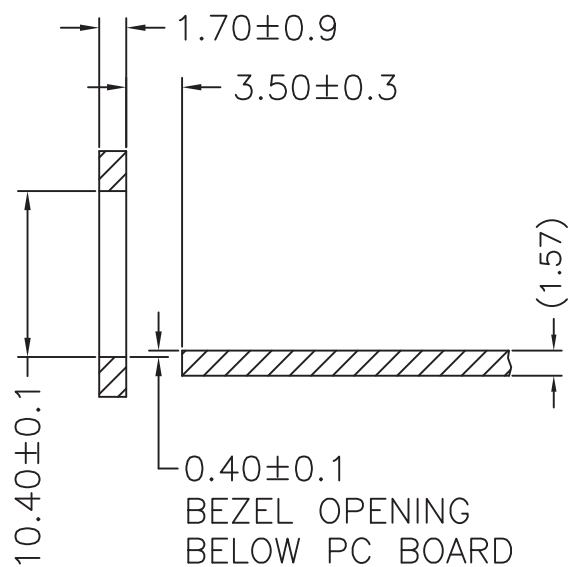

SECTION A-A

NOTES:

- △ MINIMUM PITCH ILLUSTRATED, ENGLISH DIMENSIONS ARE FOR REFERENCE ONLY



Drafted by: XiaoMing

Dimensions:mm

Unless otherwise specified, all tolerances are $\pm 0,25$

SFP Cage 1x1 Press-fit Type

Approved By: TSLEE

Part No: SFP011PA

REV.
A

SHEET 3 OF 3