

SCHEMATICS

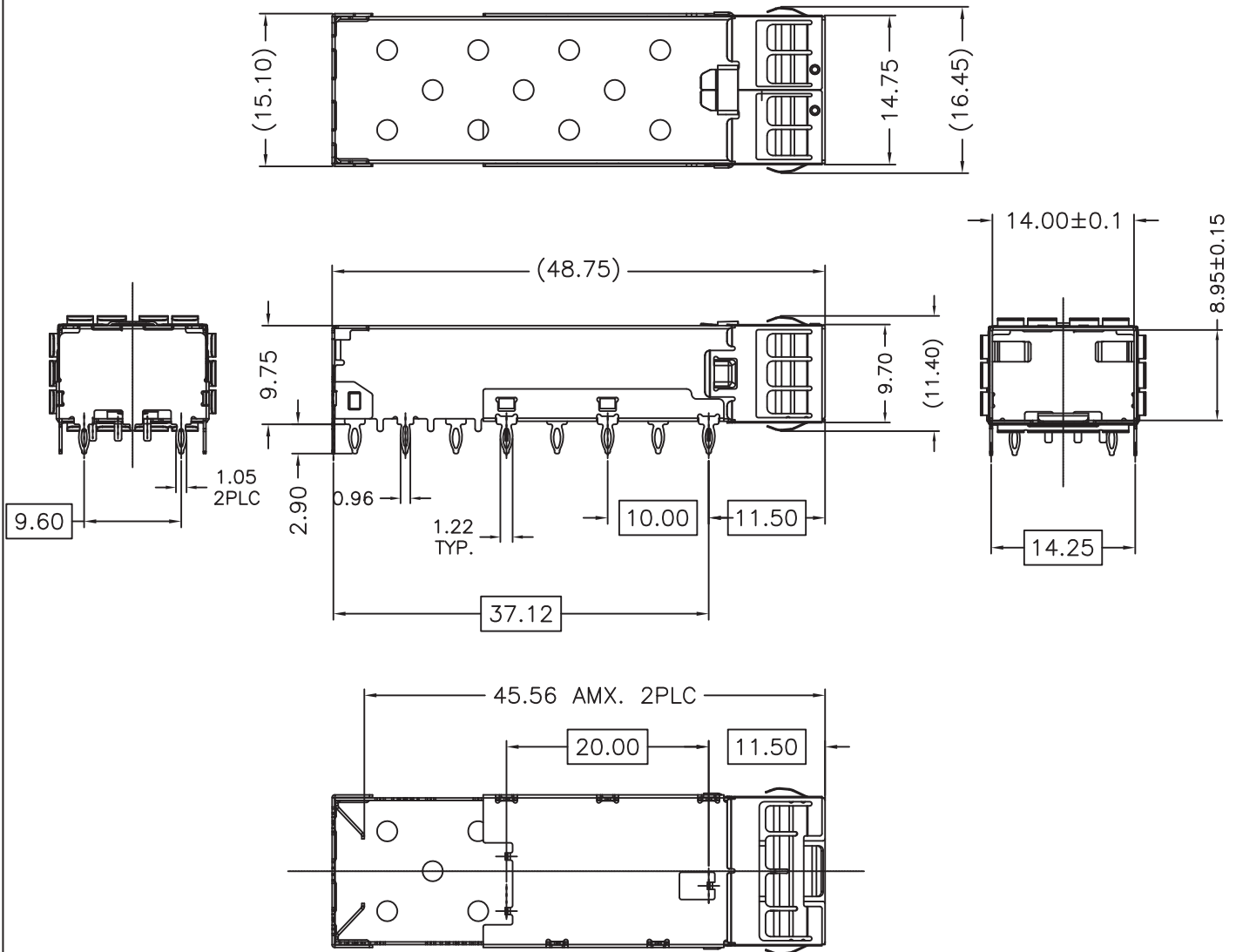

NOTES:

- 1.MATERIAL: NICKEL SILVER, THICKNESS 0.25mm
- 2.PACKAGING: TRAY PACKAGING
- 3.TEMPERATURE RANGE: -55°C TO +85°C



Drafted by:ZhangXuan

Dimensions:mm

Unless otherwise specified, all tolerances are ± 0.25

SFP+Cage 1x1 with grounding pin

Approved By: TSLEE

Part No:SFPP011PA

REV.
A

SHEET 1 OF 3



SHEET 2 OF 3

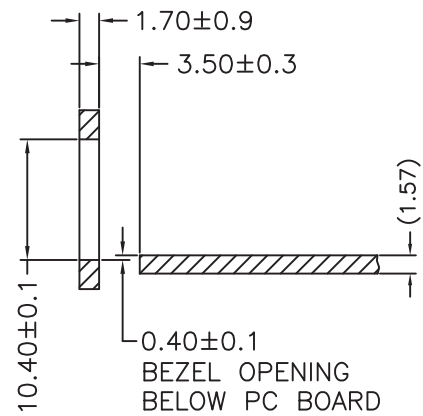
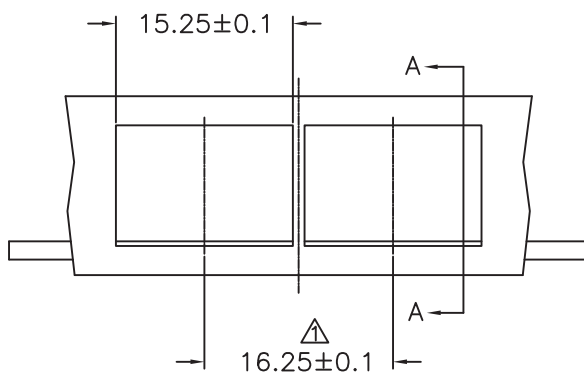

SECTION A-A

RECOMMENDED BEZEL DESIGN

NOTES:

- △ MINIMUM PITCH ILLUSTRATED, ENGLISH
DIMENSIONS ARE FOR REFERENCE ONLY



Drafted by:ZhangXuan

Dimensions:mm

Unless otherwise specified, all tolerances are $\pm 0,25$

SFP+Cage 1x1 with grounding pin

Approved By: TSLEE

Part No:SFPP011PA

REV.
A

SHEET 3 OF 3