

# SCHEMATICS

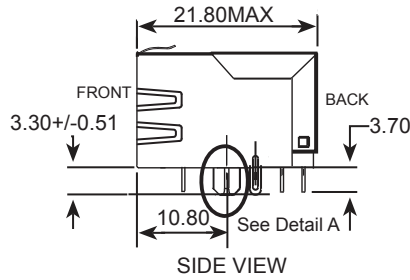

DATE CODE: YYWW  
YEAR WEEK

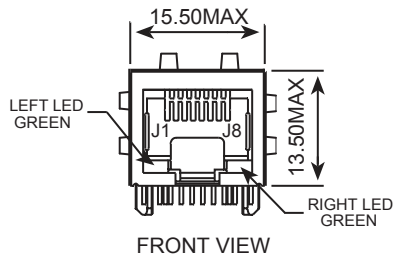
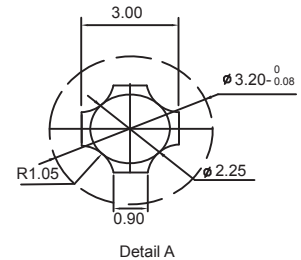
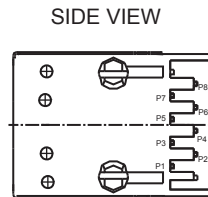
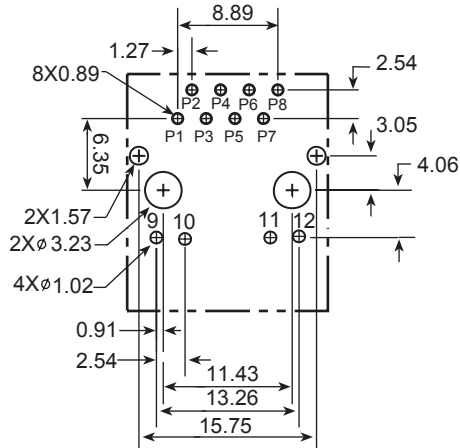

SUGGESTED PCB LAYOUT  
VIEWED FROM PCB COMPONENT SIDE

## MECHANICAL SPECIFICATIONS:

1. Housing & insert material: PBT94V-0
2. Contact material: 0.35mm phosphor bronze 30u gold plating over nickel
3. Mating/unmating force: 2.2kg. F MAX.
4. Retention strength: 9kg. F MIN between jack and plug.
5. Operating life: 600 cycle MIN.
6. The part is recommended for wave soldering process, peak temp. is 265 degree C, 5 seconds (see the wave soldering curve)
7. Jack cavity conforms with FCC part 68 subpart F (connector).
8. Shield: 0.20 ~ 0.25mm thickness brass with tin plated.

## ENVIRONMENTAL SPECIFICATIONS:

1. Storage: -40 °C ~ +85 °C Relative humidity<70%.
2. Operation: -40 °C ~ +85 °C



E328392



Drafted by:ZhangXian

Dimensions:mm  
Unless otherwise specified, all tolerances are  $\pm 0.25$

10/100BASE-T, Tab-Down  
Single, LEDs

Approved By: TSLEE

Part No: WRJ-111092ANL

REV.  
A

DATE: 2020.4.8

SHEET 1 OF 4

# ELECTRICAL CIRCUIT

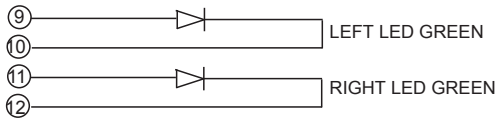
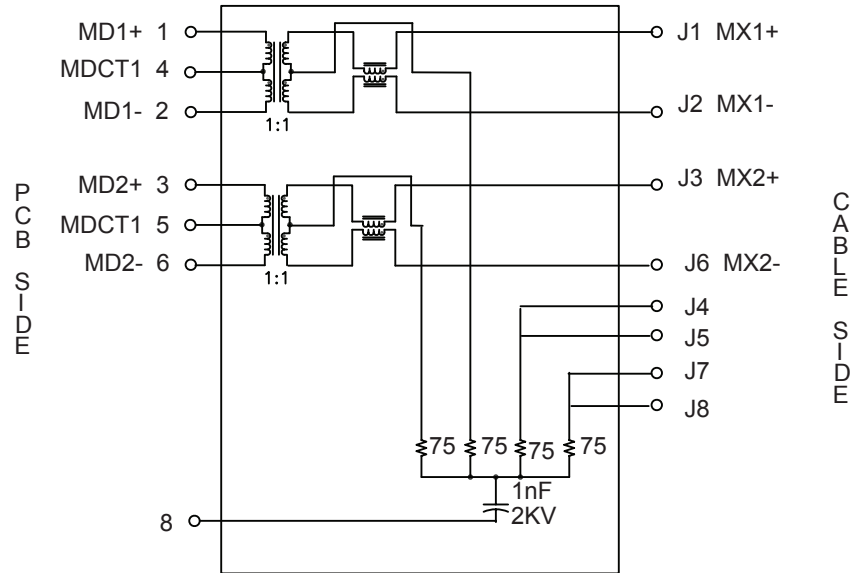

LEDs(Green)

Item	Symbol	Test condition	Min.	Type	Max.	Unit
Forward voltage	VF	IF=20mA	1.85	—	2.2	V
Reverse current	IR	VR=5V	—	—	5	μA
Luminous intensity	IV	IF=20mA	20	—	40	Mcd
Dominant wavelength	λd	IF=20mA	—	570	—	nm

## ELECTRICAL SPECIFICATIONS @25°C UNLESS OTHERWISE NOTED:

Insertion Loss: 1-100MHZ -1.0dB MAX  
 Return Loss: 1-30MHZ -18.0dB MIN  
                   30-45MHZ -16.0dB MIN  
                   45-60MHZ -14.0dB MIN  
                   60-80MHZ -12.0dB MIN  
 Crosstalk: 1-100MHZ -35.0dB MIN  
 CMR: 1-100MHZ -35.0dB MIN  
 Hipot:1500VAC 6S 1mA  
 OCL:350uH MIN @ 100KHZ 100mV 8mADC



Drafted by:ZhangXian

Dimensions:mm

Unless otherwise specified, all tolerances are ± 0,25

10/100BASE-T,Tab-Down  
Single, LEDs

Approved By: TSLEE

Part No: WRJ-111092ANL

REV.  
A

SHEET 2 OF 4

## Suggested Profile of Wave Solder for RoHS products

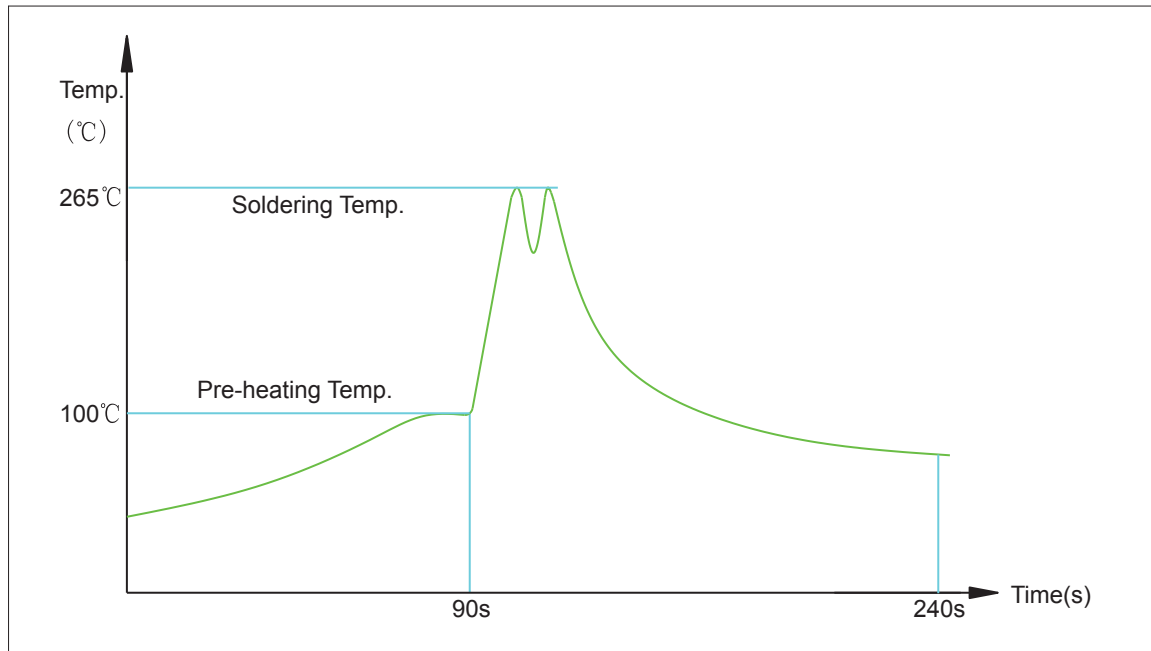

1. Maximum soldering temperature: 265°C
2. Maximum soldering time: 5 seconds
3. SnAgCu or SAC, melting point is 219 °C
4. Any plastic components located under the Printed Circuit Board / Printed Wiring Board surface might be very slightly melted by recommended temperature profile. It will however, not affect the connector function. (For example, the plastic pins of the connector)



Drafted by:ZhangXian

Dimensions:mm

Unless otherwise specified, all tolerances are  $\pm 0,25$

10/100BASE-T, Tab-Down  
Single, LEDs

Approved By: TSLEE

Part No: WRJ-111092ANL

REV.  
A

SHEET 3 OF 4

## PACKING

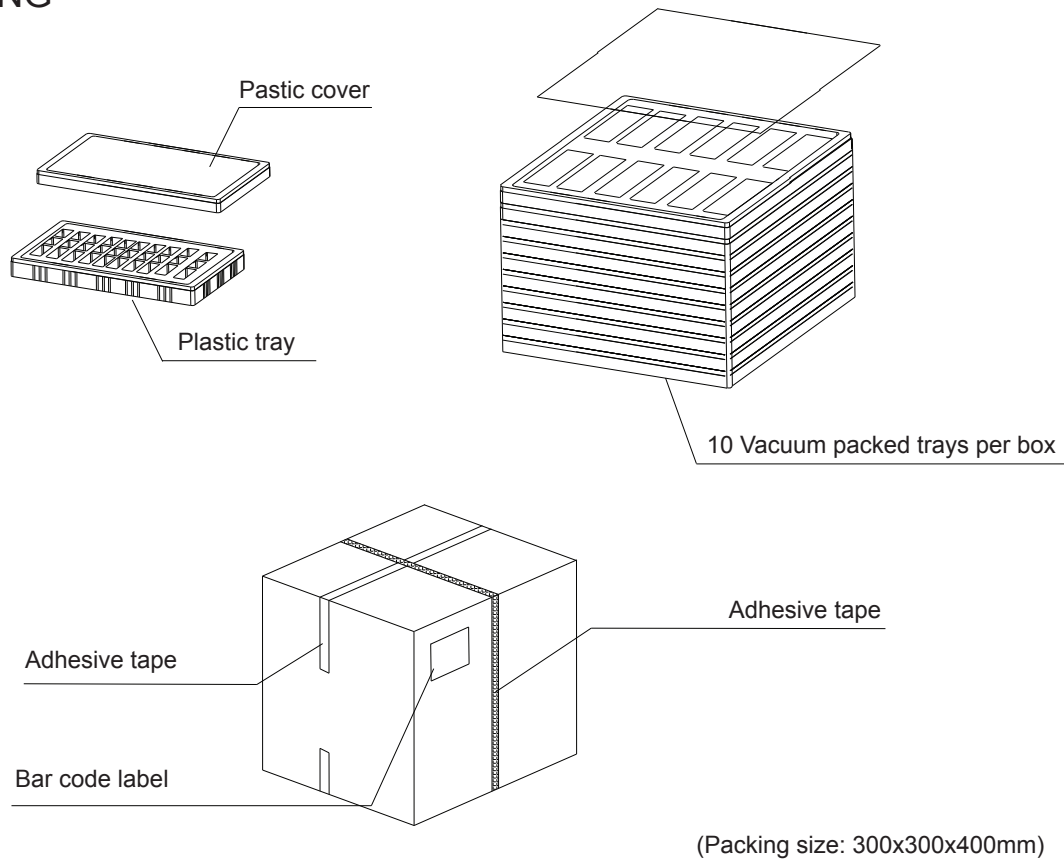

1. The connectors are placed in a plastic tray in PPC recyclable material. Each tray contains 120 connectors. Each tray has a plastic cover in PPC recyclable material.
2. A carton sheet is placed on each side of the tray. The tray is then vacuum packed in a recyclable PE bag.
3. In each box there are 10 trays placed on top of each other. Each box contains total 1200 connectors.
4. Each box dimension is 300x300x400mm or 0.036CBM with a net weight of approximately 7.5kg and a gross weight of approximately 9.1 kg.



Drafted by:ZhangXian

Dimensions:mm

Unless otherwise specified, all tolerances are  $\pm 0,25$

10/100BASE-T, Tab-Down  
Single, LEDs

Approved By: TSLEE

Part No: WRJ-111092ANL

REV.  
A

SHEET 4 OF 4